



HID-Basic ballasts for HPL and HPI(PLUS) lamps

BHL 400L 201

The HID-Basic ballast is an impregnated (HID standard) electromagnetic ballast for HID lamps, for use in combination with an external ignitor.

Product data

General Information		Temperature	
Application Code	L201	T-Winding (Max)	130 °C
		Delta-T Normal Conditions	70 °C
Operating and Electrical		Approval and Application	
Input Voltage	220 V	Approval Marks	CE marking
Input Frequency	60 Hz	Product Data	
Power Factor 100% Load (Min)	0.85	Full product code	871016314879300
Mains Voltage Performance (AC)	-8% - +6%	Order product name	BHL 400L 201
Mains Voltage Safety (AC)	-10% - +10%	EAN/UPC - Product	8710163148793
Input Current with PF Correction	2.15 A	Order code	913710101916
Input Current without PF Correction	3.25 A	Numerator - Quantity Per Pack	1
Power Factor without PF Compensation (Nom)	0.60	Numerator - Packs per outer box	6
Power Losses (Nom)	20 W	Material Nr. (12NC)	913710101916
Wiring		Net Weight (Piece)	2.640 kg
Connector Type	Screw		
System characteristics			
Rated Ballast-Lamp Power	400 W		

HID-Basic ballasts for HPL and HPI(PLUS) lamps

Dimensional drawing

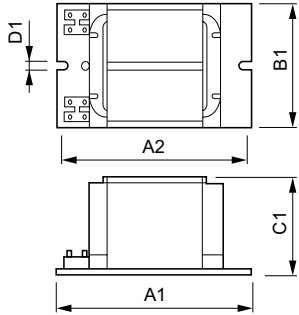

Product	D1	C1	A1	A2	B1
BHL 400L 201	6.2 mm	64.5 mm	150.0 mm	135.0 mm	75.5 mm

BHL 400 L201

